

ROOF FRAMING PLAN - AREA C
1/8" = 1'-0" 1

ROOF FRAMING NOTES:
1. SEE ROOF PLAN NOTES ON S-121A.

CRISER TROUTMAN TANNER
CONSULTING ENGINEERS NC
3809 Peachtree Ave., Suite 102
Wilmington, NC 28403
910.397.2929 Ph
910.397.2973 Fax
www.ctengineering.com
Firm License Number: F-0113
#7860-00

ARCHITECT
ksqdesign
NEW YORK OKLAHOMA NORTH CAROLINA
TEXAS COLORADO SOUTH CAROLINA

KSQ Design
1830 CAMDEN ROAD, SUITE 260
704.364.3400 office
704.364.1080 fax
www.ksqdesign.com

Owner
BRUNSWICK COUNTY SCHOOLS
189 SESSIONS DRIVE
BOLIVIA, NC 28422
910.253.2900 office
www.bcswan.net

Civil Engineer
McGILL ASSOCIATES
712 VILLAGE ROAD SW, SUITE 103
SHALLOTTE, NC 28470
910.755.5872 office
www.mcgillengineer.com

Structural Engineer
CRISER TROUTMAN TANNER
3809 Peachtree Ave., Suite 102
WILMINGTON, NC 28403
910.397.2971 office
www.ctengineering.com

MEP Engineer
KSO DESIGN
2115 REXFORD ROAD, SUITE 500
CHARLOTTE, NC 28211
704.364.3400 office
www.ksqdesign.com

Electrical Consultant
Quality Consulting Engineers, PLLC
6277-600 Carolina Commons Drive, #350
Indian Land SC 29707
(p) 803.207.5450 office
qlone@qualityconsultingengineers.com

Acoustic & Technology Consultant
THORBURN ASSOCIATES
401 N. TYRON STREET, 10TH FLOOR
CHARLOTTE, NC 28202
810.398.7828 office
www.TA-Inc.com

Building Envelope Consultant
SKA ENGINEERING
7741 MARKET STREET, SUITE F
WILMINGTON, NC 28411-9444
910.442.2000 office
www.skaeng.com

Food Service Consultant
HERBIN DESIGN
1328 DORN CIRCLE
CHARLOTTE, NC 28212-6914
704.900.0622
www.herbin.com

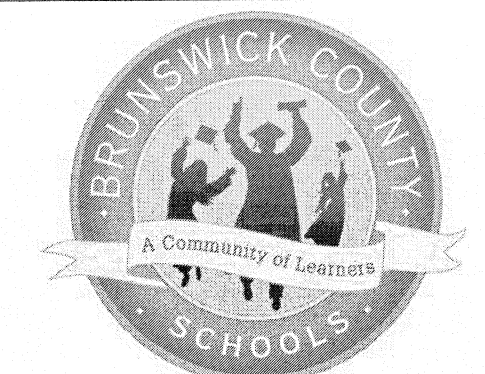
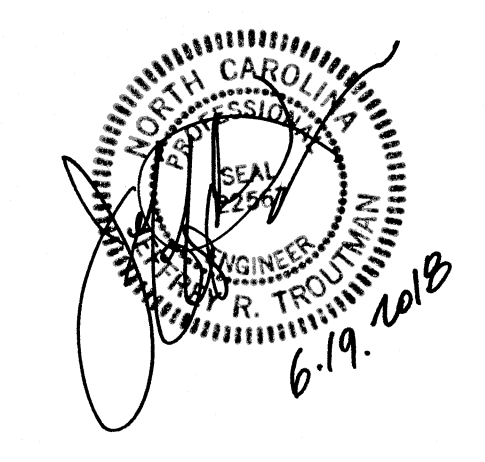

TOWN CREEK MIDDLE SCHOOL
6370 LAKE PARK DRIVE SE
WINNABOW, NC 28479

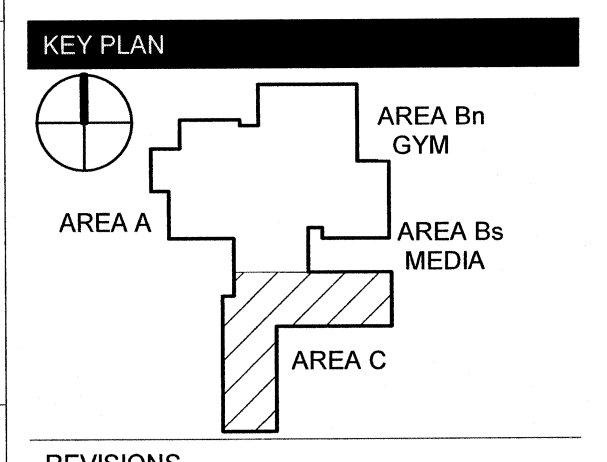

REVISIONS

| No. | Description | Date |
|-----|-------------|---------|
| 2 | Addendum #2 | 6/19/18 |

ISSUED: CONSTRUCTION DOCUMENTS

DATE: 05/24/2018
SCALE: 1/8" = 1'-0"
SHEET NAME: ROOF FRAMING PLAN - AREA C
SHEET NUMBER: S-121C